

1 Parts Identification

Item #: FT 24-72

If any pieces are missing or replacement parts are required, contact Gronomics at 1-855-299-6727.

NOTE: To unfold the trellis, hold the trellis upright and place hands as shown and pull apart.

NOTE: The trellis can be placed directly in the soil or can be secured into most raised or elevated garden beds.

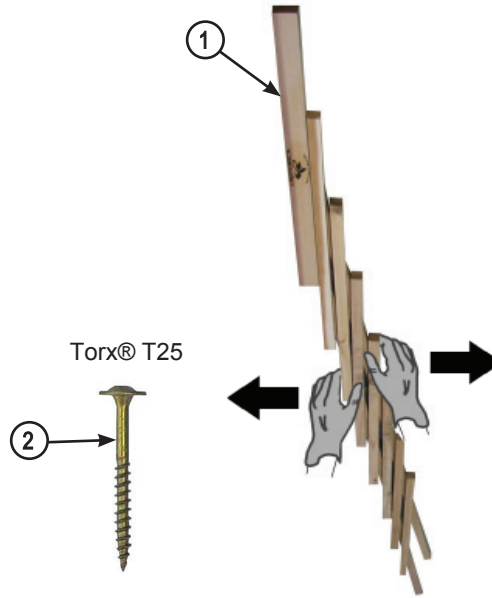

Parts List

ITEM	QTY.	PART #	DESCRIPTION
1	1	FT24-72	Folding Trellis, 24"W x 72"H
2	2	R49-112ZY	Screws, R4 #9 x 1-1/2"

Packaged & Inspected by:

Date:

Continued

2 Trellis Installation

The trellis can be mounted in several styles of garden beds, shown are two configurations.

Place the trellis (Item 1) into garden bed as shown. Align the bottom of the trellis with the bottom of the top side rail, center the trellis between the posts and make sure the trellis is straight.

Install two #9 x 1-1/2" screws (Item 2) into the pre-drilled holes.

